

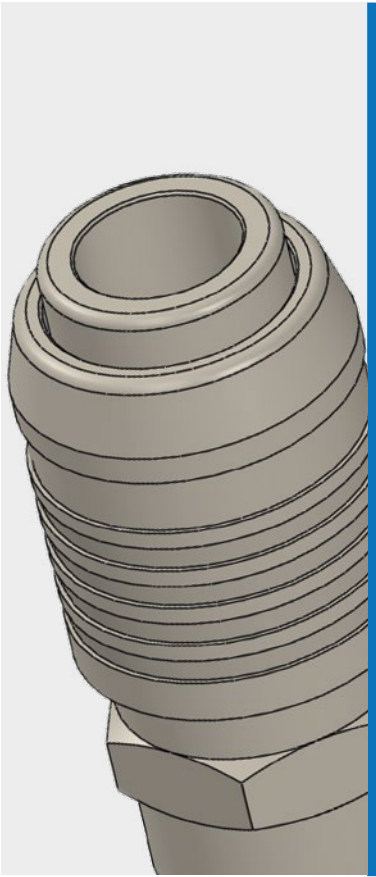

# ISO 6150 B12



 -10°C ÷ +95°C

 Working pressure  
**FLUID-10N:**  
 0-12 Bar (suggest)  
 35 Bar (max.)  
**FLUID-10S:**  
 0-7 Bar (suggest)

 Compressed air

 **DN** 5,5 mm

 - Taper gas BSPT ISO 7  
 from R 1/4" to R 1/2"  
 - Parallel gas BSPP ISO 228  
 from G 1/4" to G 1/2"

## FLOW

750 l/min (FLUID-10N)  
 840 l/min (FLUID-10S - SAFETY)

## CONFIGURATIONS

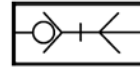

SO  
 Single  
 Shutter



Products in compliance with the directive 1907/2006



Products in compliance with the directive EU 2015/863



COMPONENTS	FLUID-10N	FLUID-10S - SAFETY
Body	Nickel plated steel	Nickel plated steel
Adapter	Nickel plated brass	Nickel plated brass
Slide	Nickel plated steel	Nickel plated steel
Valve	Nickel plated brass	Nickel plated brass
Spring	Stainless steel AISI 302	Stainless steel AISI 302
Ball	Chrome steel	Chrome steel
Retaining ring	Stainless steel AISI 302	Stainless steel AISI 302
External cartridges	-	Nickel plated steel
Seal	NBR	NBR

CONNECTION	NE-10
Body	Nickel plated steel

**FLOW DROP FLUID-10N**

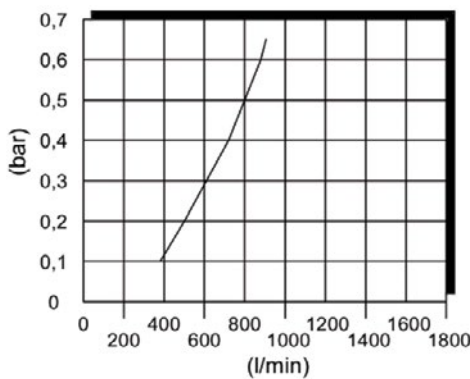

**FLOW DROP FLUID-10S**

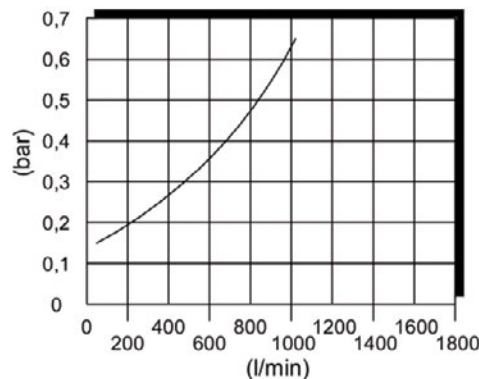

All charts have been created considering a pressure of 6 Bar with low drop of 0.5 Bar and simple lock



## FLUID-10N-M

### Male quick coupler BSPT

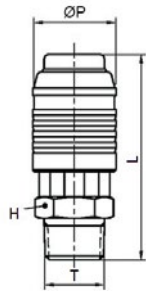

CODE	T	ØP	L	H
FLUID-10N-M1/4	R 1/4"	23,4	54,5	19
FLUID-10N-M3/8	R 3/8"	23,4	55,5	19
FLUID-10N-M1/2	R 1/2"	23,4	60	22

#### MALE QUICK COUPLER BSPP

FLUID-10N-M1/4G	G 1/4"	23,4	53	21
FLUID-10N-M3/8G	G 3/8"	23,4	54,5	21
FLUID-10N-M1/2G	G 1/2"	23,4	57,5	24

## FLUID-10N-H

### Female quick coupler BSPP

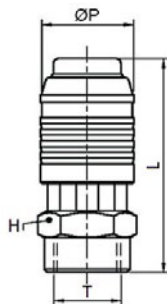

CODE	T	ØP	L	H
FLUID-10N-H1/4	G 1/4"	23,4	52,5	19
FLUID-10N-H3/8	G 3/8"	23,4	54	22
FLUID-10N-H1/2	G 1/2"	23,4	58,2	25

## FLUID-10N-E

### Quick coupler with barb connector

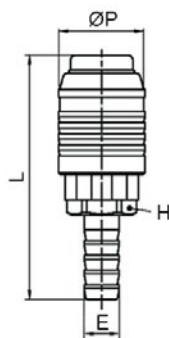

CODE	E	ØP	L	H
FLUID-10N-E6	7,2	23,4	62	19
FLUID-10N-E8	9,2	23,4	62	19
FLUID-10N-E10	11,2	23,4	66	19
FLUID-10N-E12	13,2	23,4	71	19

## FLUID-10N-PM

### Joint push-on fittings

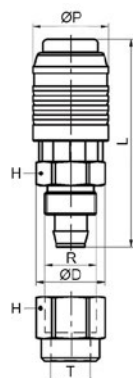

CODE	Ø TUBE	R	ØP	L	H	H1
FLUID-10N-PM08	8x12	M16x1	23,4	64,7	19	19
FLUID-10N-PM10	10x15	M20x1	23,4	69,5	22	22

To used with PU-PVC tube



## FLUID-10S-M

### Safety male quick coupler BSPT

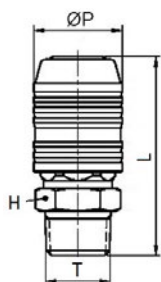

CODE	T	ØP	L	H
FLUID-10S-M1/4	R 1/4"	26,6	55,7	19
FLUID-10S-M3/8	R 3/8"	26,6	56,7	19
FLUID-10S-M1/2	R 1/2"	26,6	61,2	22
SAFETY MALE QUICK COUPLER BSPP				
FLUID-10S-M1/4G	G 1/4"	26,6	54,2	21
FLUID-10S-M3/8G	G 3/8"	26,6	55,7	21
FLUID-10S-M1/2G	G 1/2"	26,6	54,2	24

It complies with the requirements of the safety standards UNI-EN ISO 4414: 2011: Protection against accidental tearing of the tube during decompression and "whiplash" effect.

## FLUID-10S-H

### Safety female quick coupler BSPP

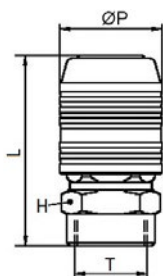

CODE	T	ØP	L	H
FLUID-10S-H1/4	G 1/4"	26,6	53,7	19
FLUID-10S-H3/8	G 3/8"	26,6	55,2	22
FLUID-10S-H1/2	G 1/2"	26,6	59,4	25

It complies with the requirements of the safety standards UNI-EN ISO 4414: 2011: Protection against accidental tearing of the tube during decompression and "whiplash" effect.

## FLUID-10S-E

### Safety quick coupler with barb connector

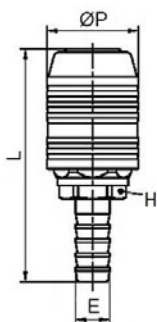

CODE	E	ØP	L	H
FLUID-10S-E6	7,2	26,6	63,2	
FLUID-10S-E8	9,2	26,6	63,2	
FLUID-10S-E10	11,2	26,6	67,2	
FLUID-10S-E12	13,2	26,6	72,2	
FLUID-10S-E13	13,8	26,6	72,2	

It complies with the requirements of the safety standards UNI-EN ISO 4414: 2011: Protection against accidental tearing of the tube during decompression and "whiplash" effect.

## FLUID-10S-PM

### Safety joint push-on fitting

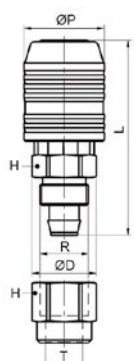

CODE	Ø TUBE	R	ØP	L	H	H1
FLUID-10S-PM08	8x12	M16x1	26,6	64,7	19	19
FLUID-10S-PM10	10x15	M20x1	26,6	69,5	22	22

To used with PU-PVC tube

It complies with the requirements of the safety standards UNI-EN ISO 4414: 2011: Protection against accidental tearing of the tube during decompression and "whiplash" effect.

## NE-10M

Male connection BSPT



CODE	T	ØD	L	CH
NE-10M	R 1/4"	8	40	14
NE-10M-3/8	R 3/8"	8	42,5	17
NE-10M-1/2	R 1/2"	8	46	22

## NE-10H

Female connection BSPP



CODE	T	ØD	L	H
NE-10H	G 1/4"	8	40	17
NE-10H-3/8	G 3/8"	8	41,5	22
NE-10H-1/2	G 1/2"	8	44	25

## NE-10E

Connection with barb connector



CODE	E	ØD	L	H
NE-10E-6	7,2	8	46	
NE-10E-8	9,2	8	47	
NE-10E-10	11,2	8	52	
NE-10E-12	13,2	8	54	

## NE-10PM

Connection with push-on fitting

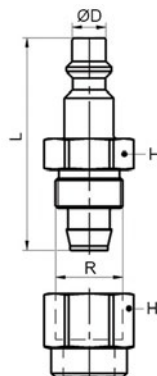

CODE	Ø TUBE	R	ØD	L	H
NE-10PM-08	8x12	M16x1	8	50,7	19
NE-10PM-10	10x15	M20x1	8	55,5	22

To used with PU-PVC tube

